

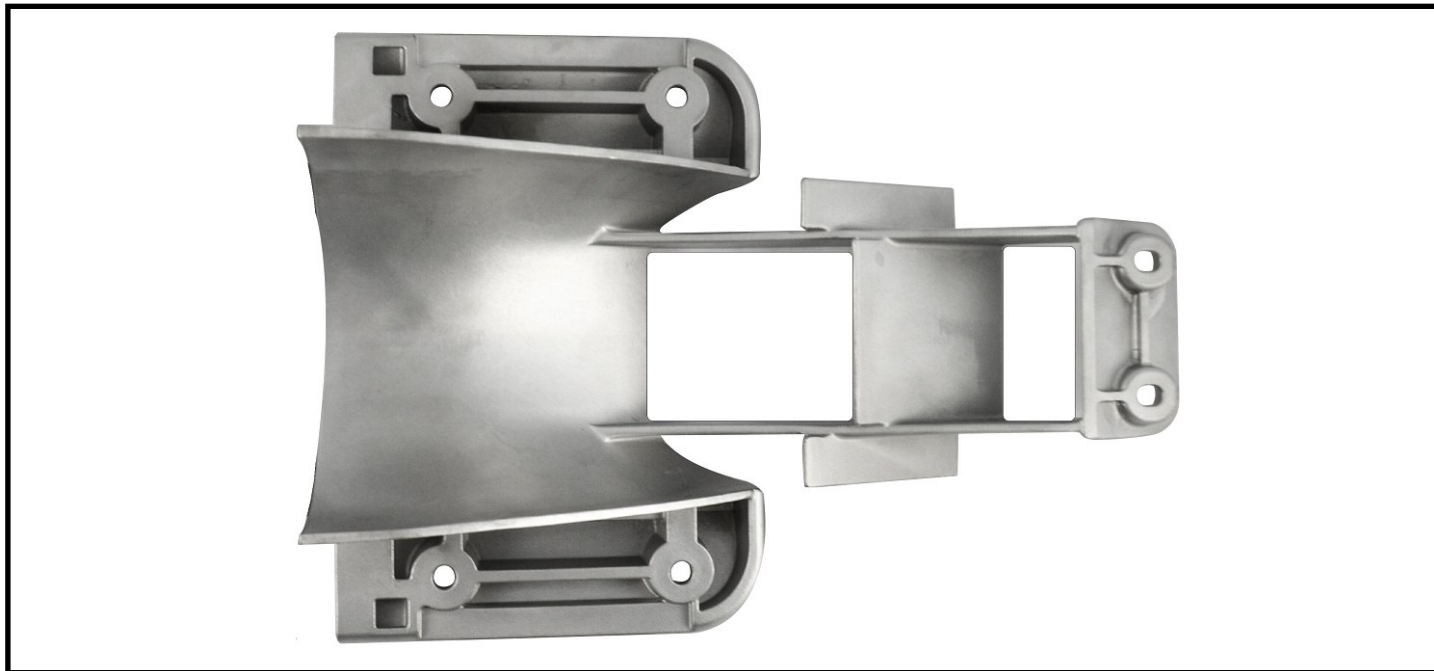

GEN-2 Top-Loader Intake Grate

RY22110-1



Applications: GP1800 2017-, VXR/S 2015-, VX Models 2015-

Approximate Installation Time: .5 HR

Recommended Specialty Tools:

N/A

Required Materials:

RIVA Pump Seal Kit

Permatex "The Right Stuff" Sealant

Blue Loctite Thread Locker

Part #

Part #

RY25110-1

N/A

N/A

GET THE LATEST UPDATES!

Prior to installation, go to the RIVA Racing online Instruction Library to download the latest version of these instructions:

<https://rivaracing.com/instructions>

We strongly recommend the use of a service manual to familiarize yourself with the various components and procedures involved with this installation. Please note that some of the original hardware removed in the disassembly process will be used in the installation process. These instructions have been written in step-by-step format and refer to illustrations. Read through instructions entirely before performing installation. Please follow these step-by-step instructions and illustrations carefully.

***** ALLOW ENGINE TO COOL COMPLETELY BEFORE PERFORMING INSTALLATION *****

***** NO SMOKING *** NO SMOKING *** NO SMOKING *****

- INSTALLATION INSTRUCTIONS -

Loosen ride plate bolts (4) to allow front end of ride plate to drop down. (A in Figure 1) **Note: If bolts will not turn apply heat to heads of bolts.**

Remove bolts (6) holding OEM intake grate. **Note: If bolts will not turn apply heat to heads of bolts.** (B in Figure 1)

Figure 1

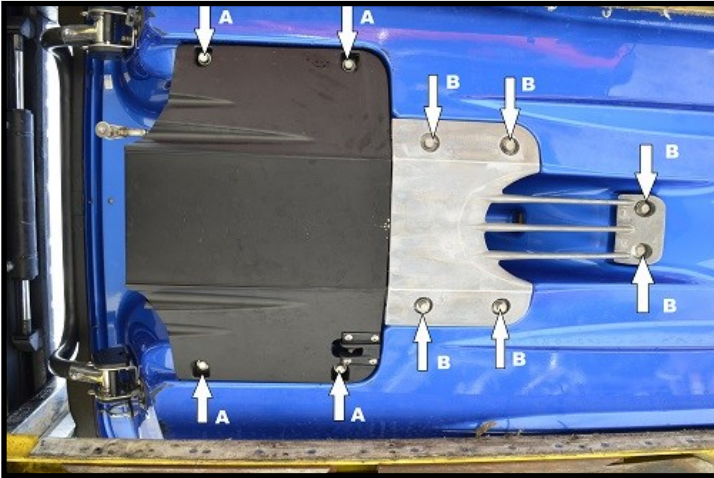

Remove OEM intake grate pulling down and forward on the front end of the intake grate to disengage it from the craft.

At the rear of the intake grate is the OEM spacer. Made of a black rubber-like material, it is normally trapped between the front of the ride plate and the transom plate. If it did not come out with the intake grate remove it now. Loosen the ride plate more if necessary to get it to slide out easily.

This intake grate must be installed with the appropriate pump seal kit RIVA part # RY25110 to prevent cavitation.

Figure 2 shows the intake grate and pump seal kit components.

Pump seal parts B, C, D, E, F, and G should be inserted into the cavities from the rear of the intake grate.

Push seals E and F all the way into the intake grate to cover the holes.

H, I, J, K, L, and M should be installed from the top of the grate.

Hint: A spot of silicone sealer into each of the cavities before inserting the pump seals will help hold the pieces in place during installation of the grate.

The OEM spacer (A in figure 2) should be inserted last into the rear end of the ride plate. It will fit under seals B and C and fill the end of the cavities for E and F. The rear end of the OEM spacer will project out from the intake grate as shown in Figure 3.

Figure 2

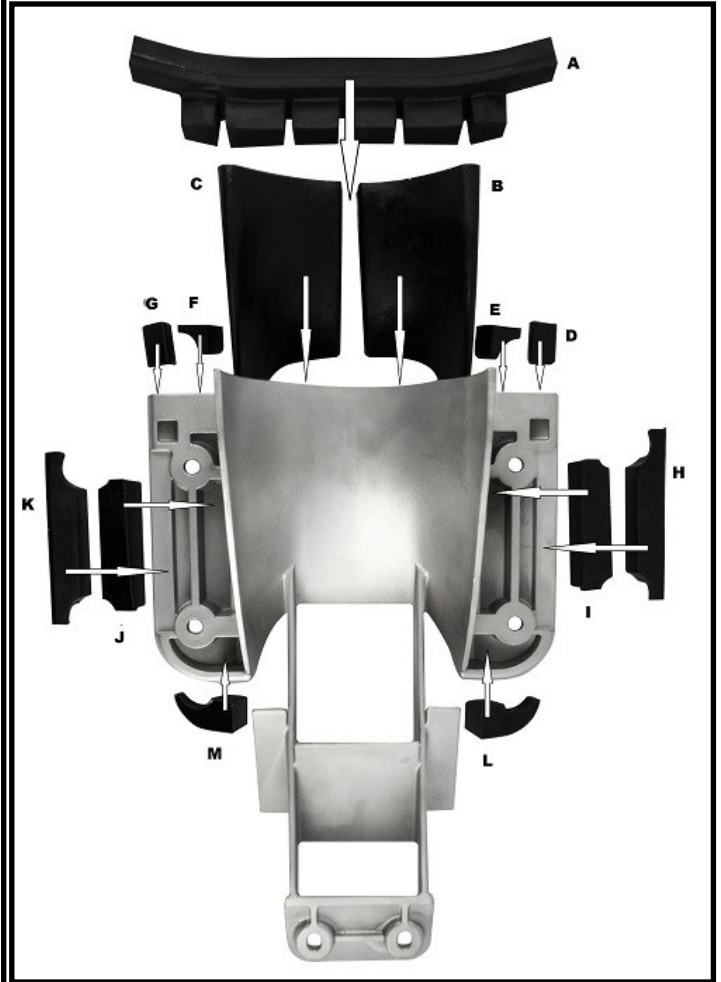
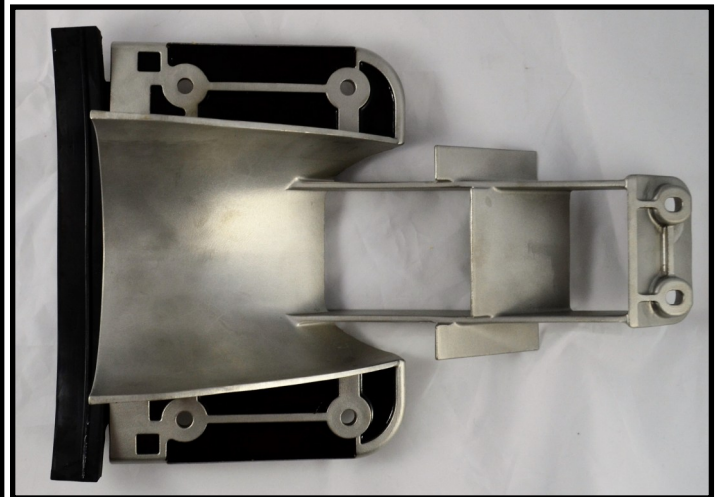
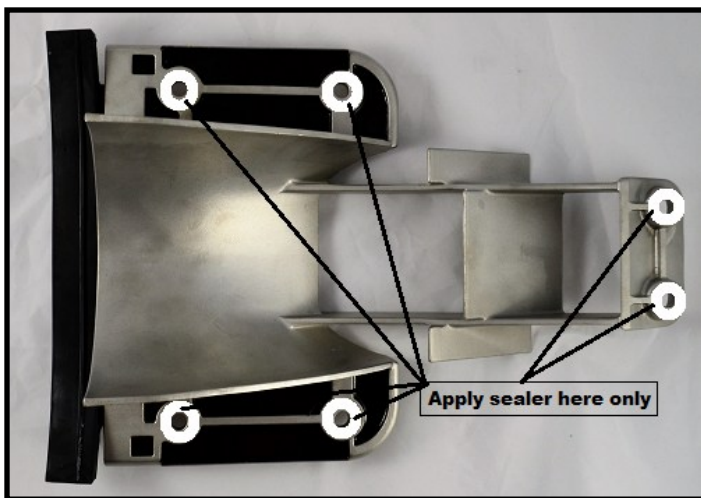

Figure 3



Apply a small amount of "The Right Stuff" silicone sealer on the top surface of the intake grate around the bolt holes only as shown in Figure 4.

Figure 4



Install the intake grate on the ski inserting the OEM spacer at the rear of the grate into the gap between the ride plate and pump support. Install OEM bolts (6), previously removed and torque to 12.5 lb.ft. (17NM). **Note: Apply blue Loctite to bolt threads.**

Tighten ride plate bolts (4). Torque to 12.5 lb.ft. (17NM)
Note: Apply blue Loctite to bolt threads.

Place a bead of "the Right Stuff" silicone sealer into the gap around the intake grate and ride plate. Level the bead to fill the gap. Wipe off any excess sealer.

Check craft for tools, rags, etc. Run craft on a flush kit to check for proper operation.

***Remember, the water belongs to everyone.
Please ride responsibly and respect the environment!***

Technical Support

For answers to questions regarding installation or trouble shooting RIVA Performance Products contact:

RIVA Technical Support directly at (954) 247-0705 or by e-mail at tech_support@rivaracing.com.

Limited Warranty

RIVA Intake grates carry a 1 year limited warranty to the original purchaser. They are warranted to be free of defects in materials and workmanship under normal use and service. Customer modified components will be void of warranty. This warranty is limited to defects in the primary components only. Finish and/or wear marks in or on primary components are not covered under this warranty.

RIVA Racing's liability is expressly limited to the repair or replacement of the components contained within or associated with this kit. RIVA Racing agrees to repair or at RIVA's option, replace any defective unit without charge, if product is returned to RIVA Racing freight prepaid within the warranty period. Any equipment returned which, in RIVA's opinion, has been subjected to misuse, abuse, overheating or accident shall not be covered by this warranty.

RIVA Racing shall have no liability for special, incidental or consequential damages or injury to persons or property from any cause arising from the sale, installation or use of this product.

No other warranty, express or implied, including, but not limited to the implied warranties of merchantability and fitness for a particular purpose, applies. Various states do not allow for the limitation of incidental or consequential damages and therefore the above exclusion or limitation may not apply to you.

Warranty does not include the expenses related to freight or transportation of parts or compensation for any inconvenience or loss of use while being repaired. A copy of the original invoice and a Return Authorization Number (RA#) must accompany all warranty claims.

Warranted replacement parts will be returned freight collect.